

## Power-On Operation

1. Power on the device with 12V/1A power supply and wait until the device **Call button** light turns **RED** breathing light and hear the bee tone from E12W.

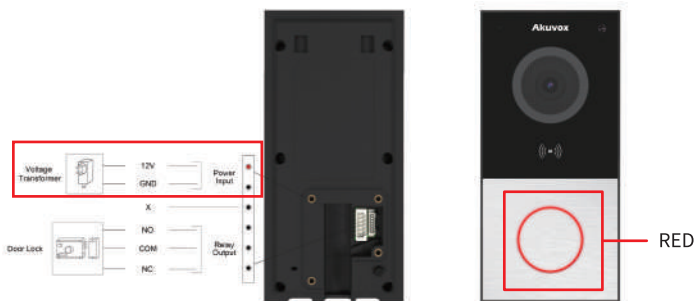

## Wi-Fi Configuration

2. Press the **Tamper-proof button** three times to enter the the Wi-Fi scanning mode as indicated by the **BLUE** flashing light on the card reader area. And wait until the **BLUE** light stays constant ,when the device has finished Wi-Fi scanning and entered **Network Pre-configuration mode**, which lasts for only 20 seconds before it expires.

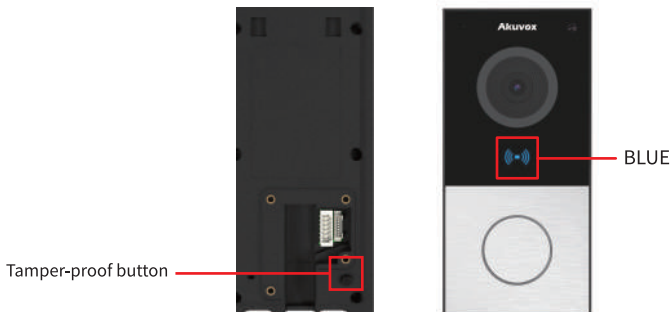

3. Before **Network Pre-configuration** mode expires, long press the **Call button** for 3 seconds to enter the **Network Configuration** mode, when the device will automatically enable its hotspot feature while creating a hotspot access connection named E12-XXXX with no access password. "XXXX" is the last four digits of the device's MAC address.

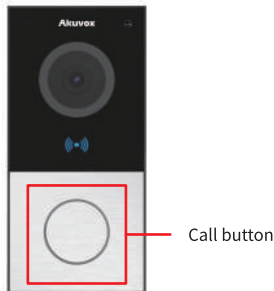

4. Open the WLAN feature on your mobile phone, find the Wi-Fi named "**E12-xxxx**", click "connect". During this process, the **Call button BLUE** light will keep flashing. And now you will have only 5 minutes to finish the device Network configuration on your mobile phone via Hotspot, because both the **Network Pre-configuration** mode and **Network Configuration** mode will expire in 5 minutes.

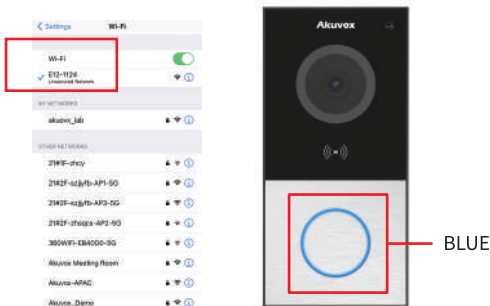

5. After your mobile phone is connected to the hotspot successfully, your mobile phone will automatically open the browser and enter the Wi-Fi Configuration page. You can also type the hotspot IP address 192.168.188.10 on the mobile phone's browser to enter the configuration page. Now, you can select the Wi-Fi network you want the device to be connected to, and enter the corresponding Wi-Fi password, and tap **Connect** button.



6. During connection process, the **Call button BLUE** light keeps flashing. If successfully connected to the Wi-Fi, you will see the **Call button BLUE** light stays on and hear prompt sound for the successful connection. If the connection failed, you will see **PURPLE** flashing light, requiring you to proceed from step 1.

**Note:** In this step, you can always press **Tamper-proof button** 3 times to proceed from the step1 if anything goes wrong such as having entered the incorrect password.



BLUE



PURPLE

## Indicator Light

Mode	Indicator Status
Power on without network	Call button: Red light flashes once every 400ms
Wi-Fi scanning mode	Card reader area: flashes once every 400ms. Call button: always off
Pre-configuration mode	Card reader area: always on Call button : always off
Network configuration mode	Card reader area: always off Call button: Blue light flashes once every 400ms
Connect Wi-Fi	Success: Card reader: always off Call button: blue light is always on
	Failed: Card reader: always off Call button: Purple light keeps flashing for 400ms

### Notice Information

Information contained in this document is believed to be accurate and reliable at the time of printing. This document is subject to change without notice, any update to this document can be viewed on Akuvox' s website: <http://www.akuvox.com> © Copyright 2021 Akuvox Ltd. All rights reserved.



**AKUVOX (XIAMEN) NETWORKS CO., LTD.**  
ADD: 10/F, NO.56 GUANRI ROAD, SOFTWARE PARK II, XIAMEN 361009, CHINA  
[www.akuvox.com](http://www.akuvox.com)



YS12000025